

1. Scope as per Clauses 1.0 and 9.4 E2/AS1
2. Profiles as per NZS 3617 Branz Bulletin 411
3. Fixings as per Table 24 E2/AS1
4. Compatibility of materials as per Tables 20-22 E2/AS1
5. Flashing as per Clause 4.0 E2/AS1
6. Rigid and flexible underlay as per Table 23 and Clauses 9.1.5 to 9.1.7 E2/AS1 or proprietary approved alternative
7. All weatherboards to be factory oiled to all faces and weathergrooves prior to installation
8. The weatherboard system relies on the joinery meeting the requirements of NZS 4211 for the relevant building windzone or wind pressure.
9. Timber to NZBC B2 Durability B2.3.1, Western Red Cedar, Larch and Truwood

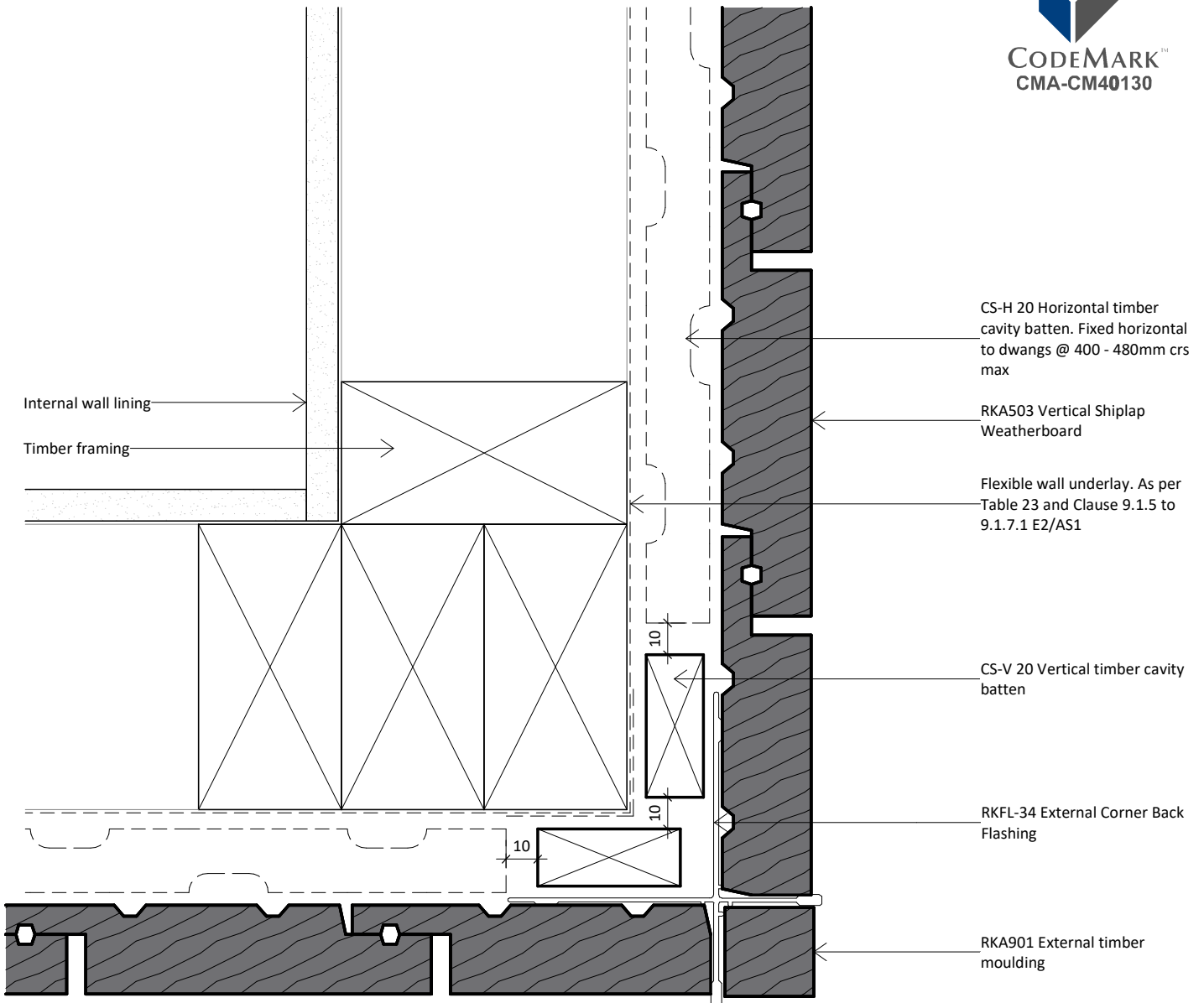

www.rosenfeldkidson.co.nz

Postal address: PO Box 621,  
Shortland Street, Auckland 1140

**Auckland Branch:**  
T: +64 9 573 0503  
F: +64 9 573 0504  
513 Mt Wellington Highway  
Mt Wellington, Auckland 1060

**Christchurch Branch:**  
T: +64 3 349 3316  
F: +64 3 349 3317  
15 Edmonton Road  
Hornby, Christchurch 8042

Title **External Corner Detail - Option 8**

Drawing **RKV20-FU-28**

Scale 1 : 2 @ A4 Date 12.10.2018