

1. Scope as per Clauses 1.0 and 9.4 E2/AS1
2. Compatibility of materials as per Tables 20-22 E2/AS1
3. The flashing system relies upon the joinery meeting the requirements of NZS 4211 and for the relevant building wind pressures
4. Intersect flashings are designed exclusively for use with the Rosenfeld Kidson Cedarscreen Vertical 45mm system
5. Windows to have a 10 mm perimeter clearance for application of a continuous air seal

 <p>INTERSET RECESSED WINDOWS FOR TIMBER CLADDING</p> <p>www.rosenfeldkidson.co.nz</p>	Rosenfeld Kidson & Co. Ltd		Title Window Right Hand Mitre Jamb Detail Option 2
	Auckland Branch: 513 Mt Wellington Highway Mt Wellington, Auckland 1060 T. +64 9 573 0503 F. +64 9 573 0504	Christchurch Branch: 15 Edmonton Road, Hornby Christchurch 8042 T. +64 3 349 3316 F. +64 3 349 3317	Drawing RK-RWF-11
Postal address: PO Box 621, Shortland Street, Auckland 1140			Scale: 1:2 @ A4

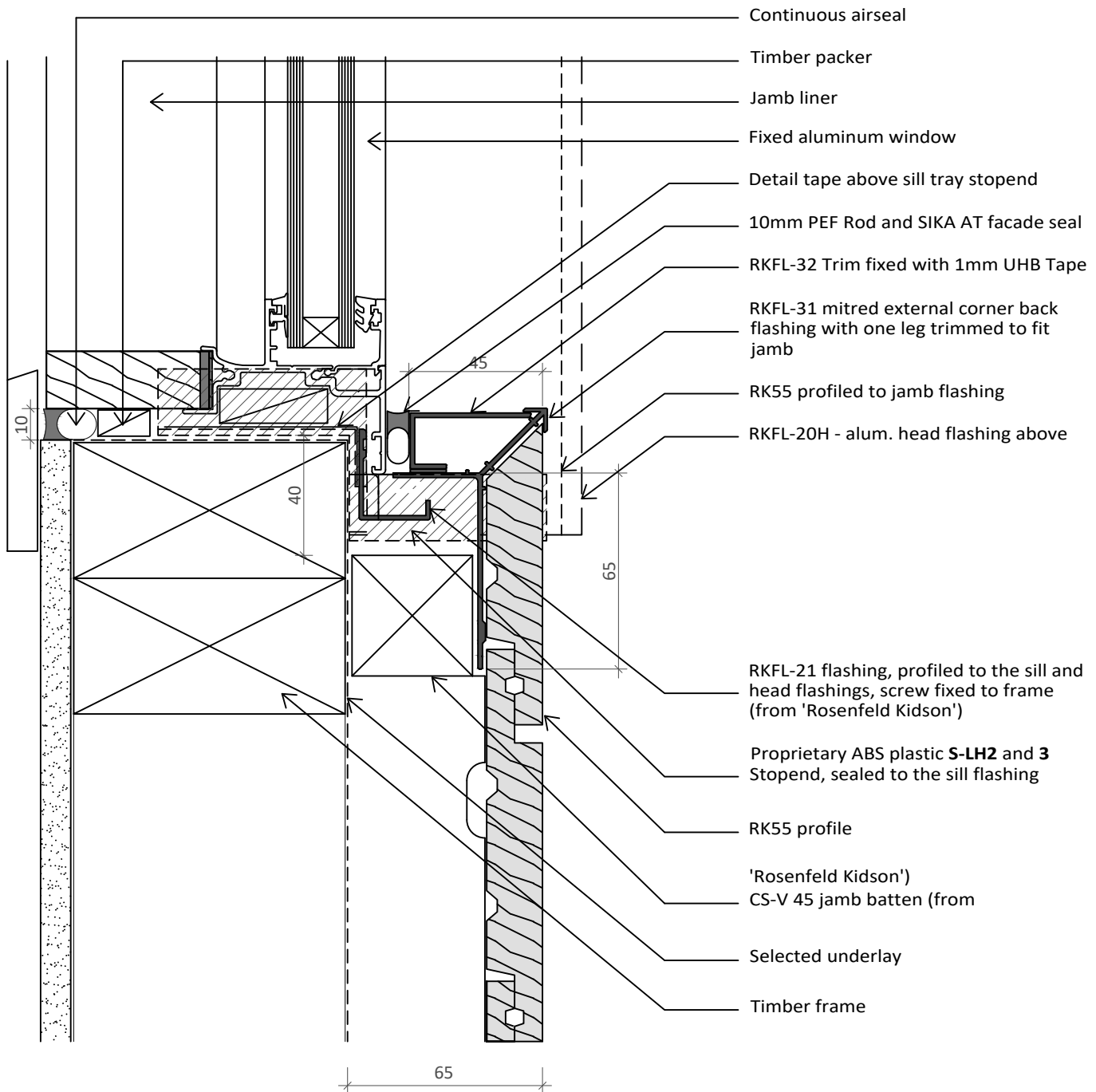

1. Scope as per Clauses 1.0 and 9.4 E2/AS1
2. Compatibility of materials as per Tables 20-22 E2/AS1
3. The flashing system relies upon the joinery meeting the requirements of NZS 4211 and for the relevant building wind pressures
4. Intersect flashings are designed exclusively for use with the Rosenfeld Kidson Cedarscreen Vertical 45mm system
5. Windows to have a 10 mm perimeter clearance for application of a continuous air seal



www.rosenfeldkidson.co.nz

Rosenfeld Kidson & Co. Ltd

Auckland Branch:
513 Mt Wellington Highway
Mt Wellington, Auckland 1060
T. +64 9 573 0503
F. +64 9 573 0504

Christchurch Branch:
15 Edmonton Road, Hornby
Christchurch 8042
T. +64 3 349 3316
F. +64 3 349 3317

Postal address: PO Box 621, Shortland Street, Auckland 1140

Title

**Window Left Hand Mitre Jamb Detail
Option 2**

Drawing

RK-RWF-11

Revision: F

Scale: 1:2 @ A4

Date: 26.09.2018